



KISTLER

CUTTING AND WELDING TECHNIQUES



Company Profile



Table Of Contents

01
Introduction

02
Company
History

03
Acquisitions

04
Fields of
Application

05
Standard-
Automation
Equipment

06
Value
Added
Products

07
Advantages of
USP Products

08
References

09
Contact
Information





Today's Speakers

Today, two professionals will introduce you to the Kistler company and its strengths.

However, feel free to ask should you have questions at any time.



Mr. Alex Kistler
Chief Executive Officer

alex.kistler@kistler-machine.de
+49 177 3088150



Mr. Gerald Obritzberger
Business Development USA

ussales@kistler-machine.de
+1 (312) 547-9253

Who are we?



Worldwide leading manufacturer of welding positioning and cutting machines for the welding trade, especially for the automation of cutting and welding processes

Our Philosophy

It is the intent of KISTLER to provide quality welding positioning and cutting equipment to the welding industry at a reasonable price to a mutually acceptable schedule.

- **Alex Kistler, CEO**

 **KISTLER**
CUTTING AND WELDING TECHNIQUES

”



Company History



6/1/1966

Founding of the Kistler company by Roland Kistler



10/1/1989

Takeover by Alex Kistler and Transformation of the Kistler company into a GmbH



3/1/1990

Start of the first own production in Bierstetten in the South of Germany



7/1/1999

Opening of the second building in Bierstetten



4/30/2007

Opening of a new workshop in Bad Saulgau (1500 m² production area)



4/5/2013

Expansion of the workshop and offices by 100% (3000 m² production area)

Growth is never by mere chance; it is the result of working together.



Acquisitions

Kistler has taken over two subsidiaries and integrated them into the main company in order to expand the machine portfolio to over 2.000 models and to gain advantages over the competition.

In addition, Kistler is now able to offer complete solutions including the technically demanding welding heads from a single source.



**F. Bode &
Sons (UK)**



**UP Helfert
GmbH (DE)**

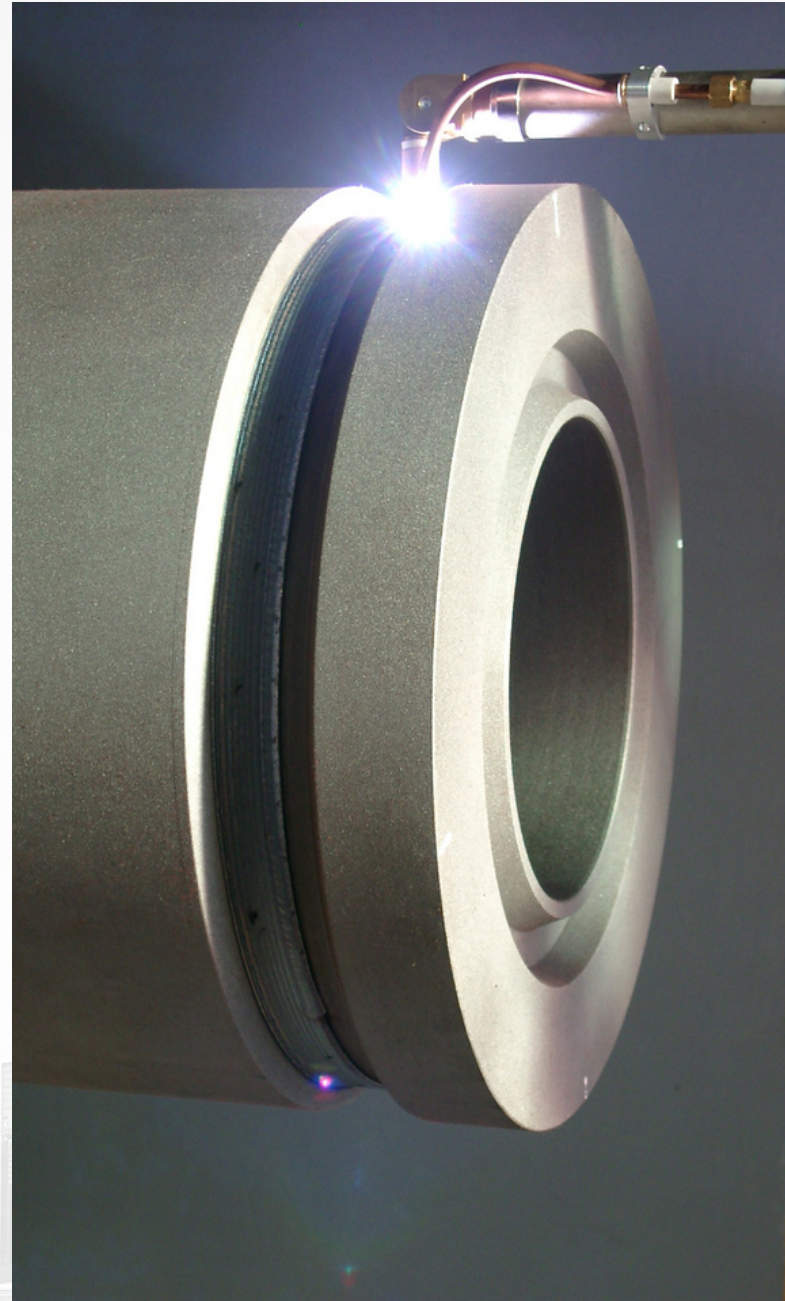
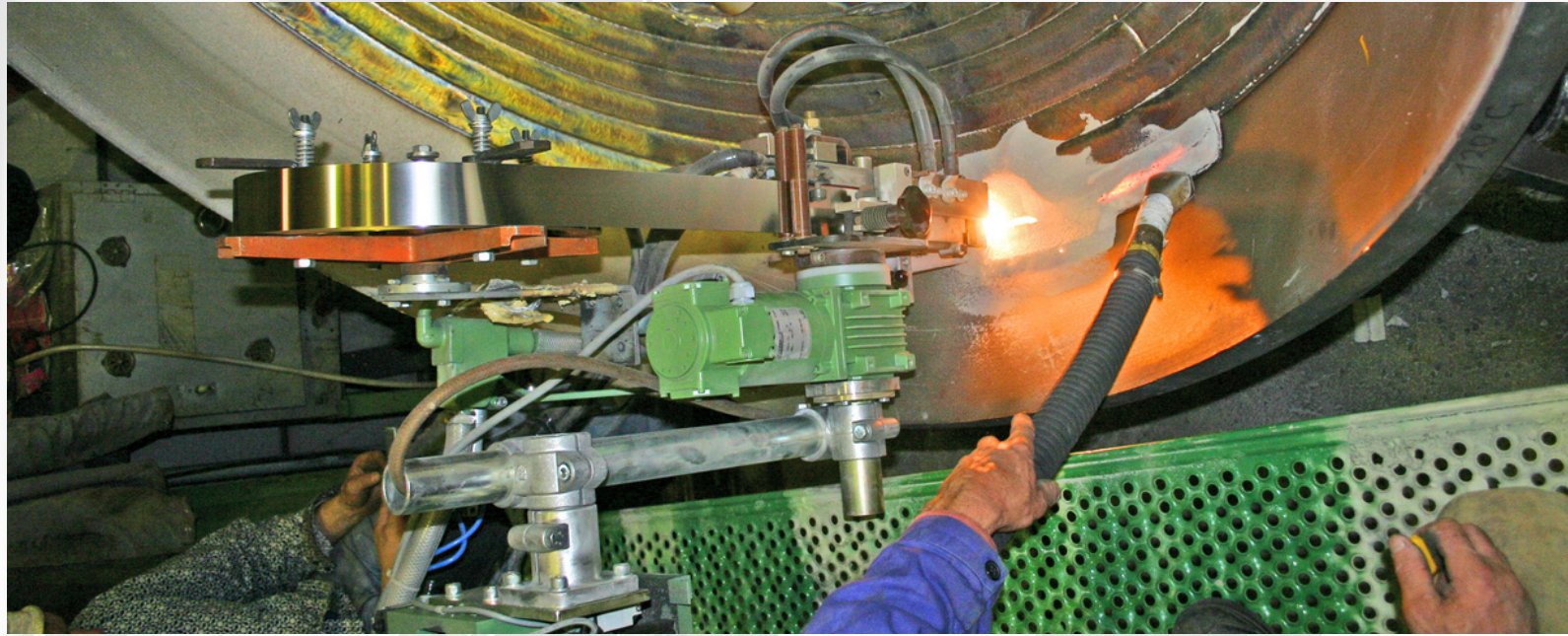

Fields of Application

Among others the main fields for submerged arc welding applications are **Strip Cladding, Pipe Mill Equipment** and **Onshore & Offshore Wind Energy Production**

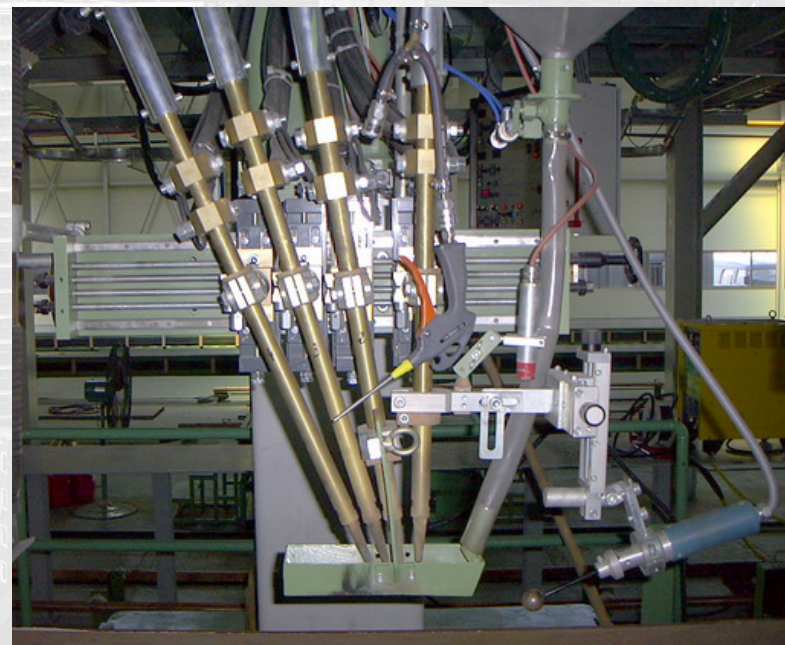

Standard-Automation Equipment

Positioners of various designs and capacities from 50 kg / 100 lbs up to 100 tons



R500

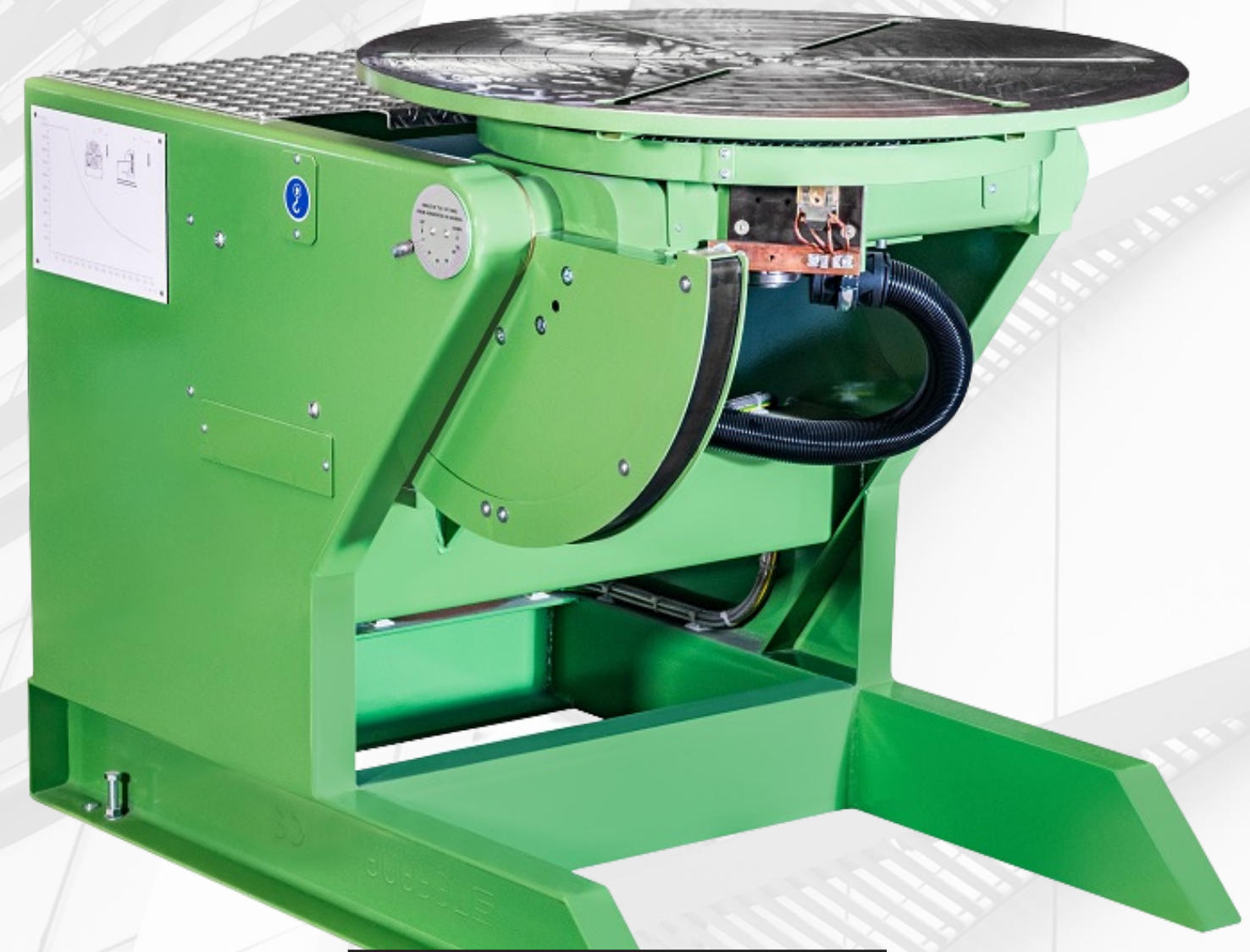

20VP

Standard-Automation Equipment

Positioners of various designs and capacities from 50 kg / 100 lbs up to 100 tons



VP50H



L1500

Standard-Automation Equipment

Positioners of various designs and capacities from 50 kg / 100 lbs up to 100 tons



HP7500

Standard-Automation Equipment

Rotators (conventional, self-aligning, stationary, traversing) with capacities from 1 ton up to 1400 tons

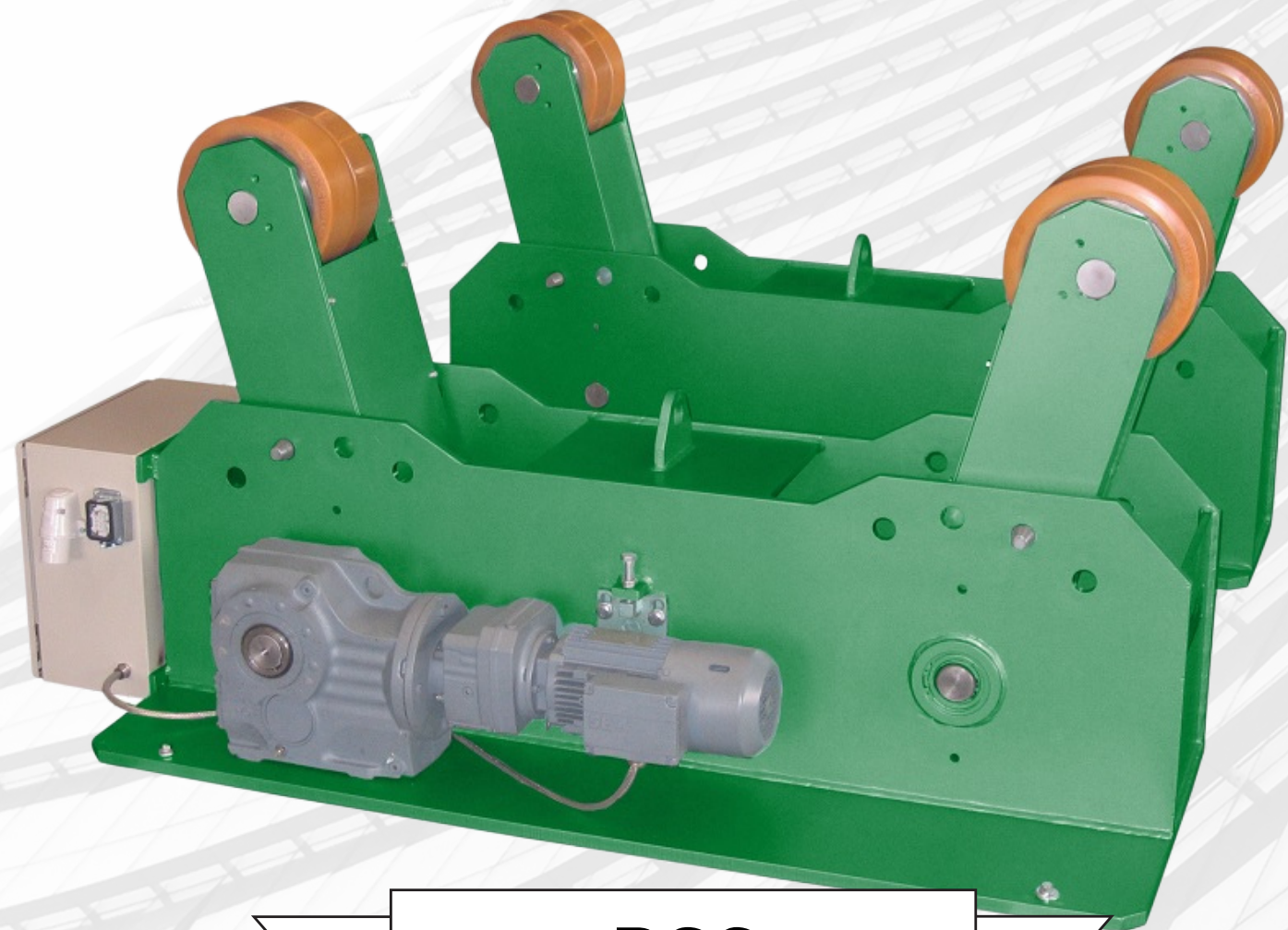

RS6

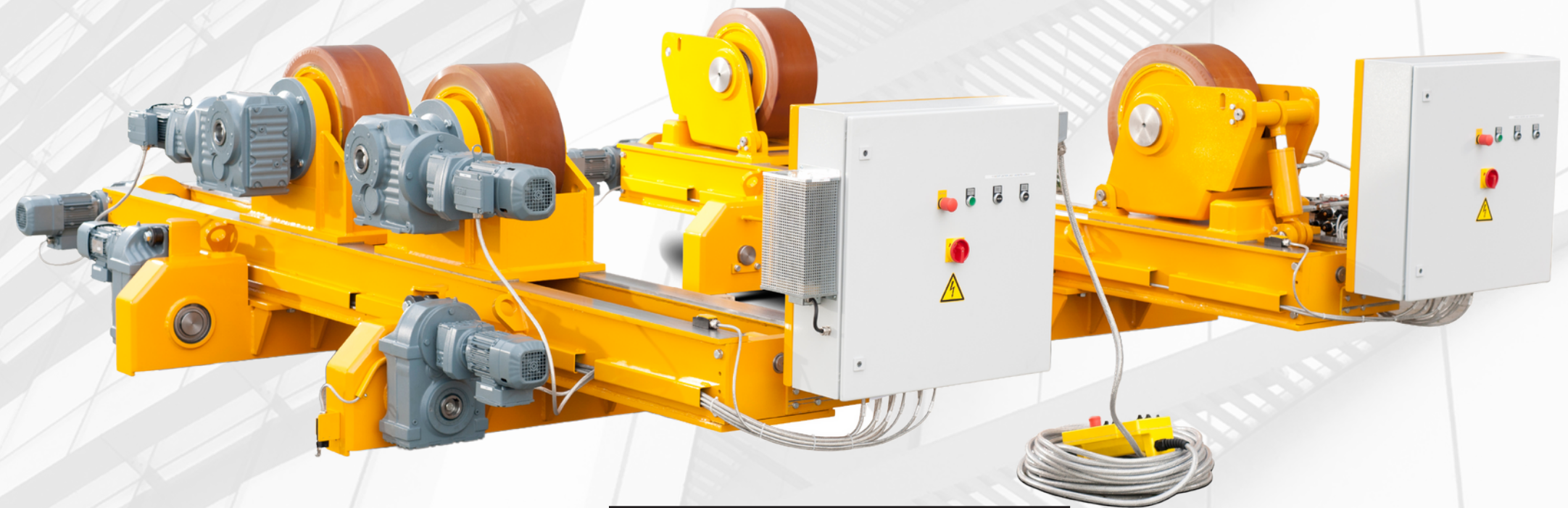

TRS60H

Standard-Automation Equipment

Column & Boom manipulators for various purposes and loads
from 2 m x 2 m / 6.5' x 6.5' up to 6 m x 6 m / 20' x 20'



TRCX

Standard-Automation Equipment

Specials such as Quick clamping chucks and gripper chucks

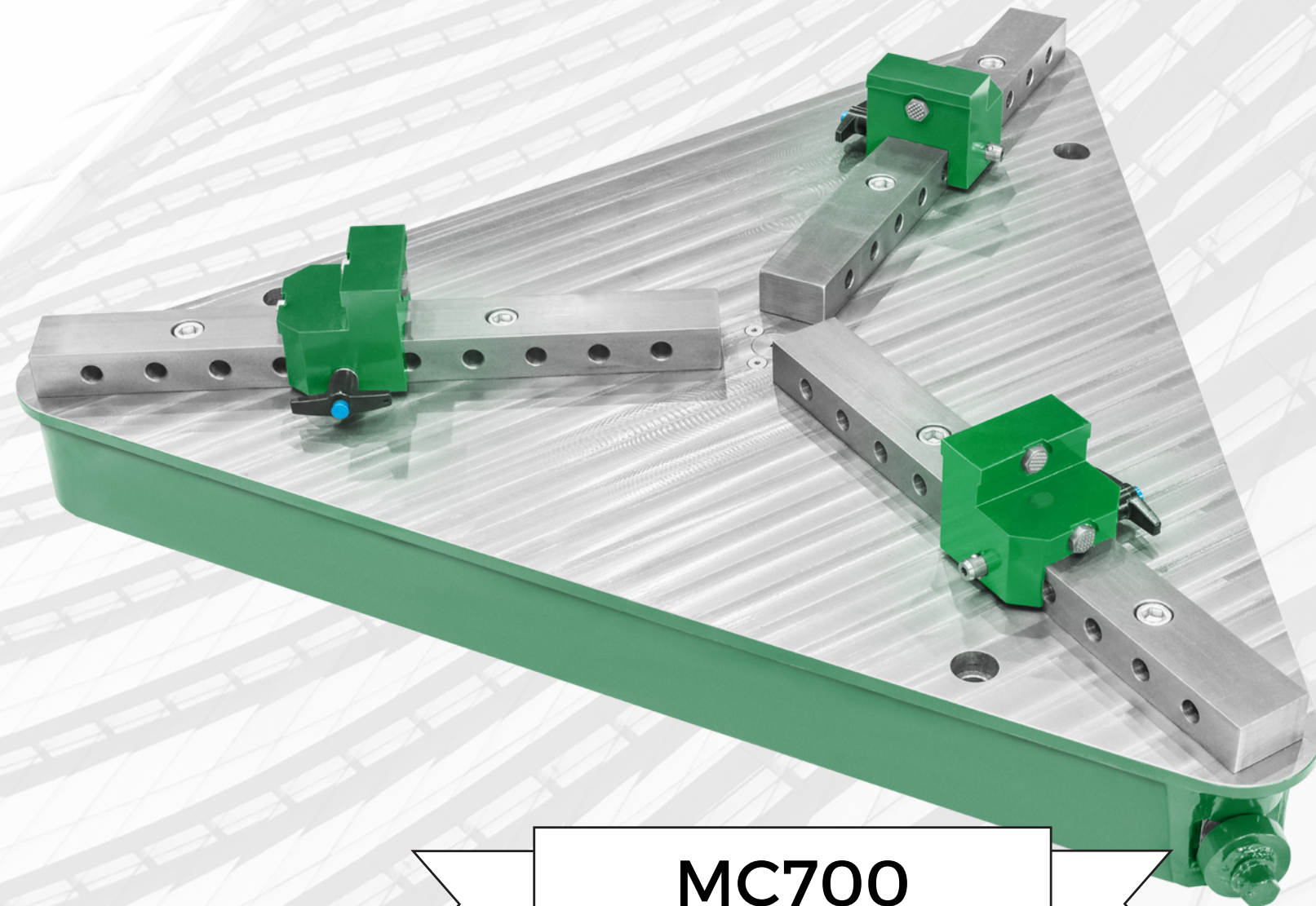

MC700



Standard-Automation Equipment

H Beam Welding Lines of the VBL- & LBL-Range

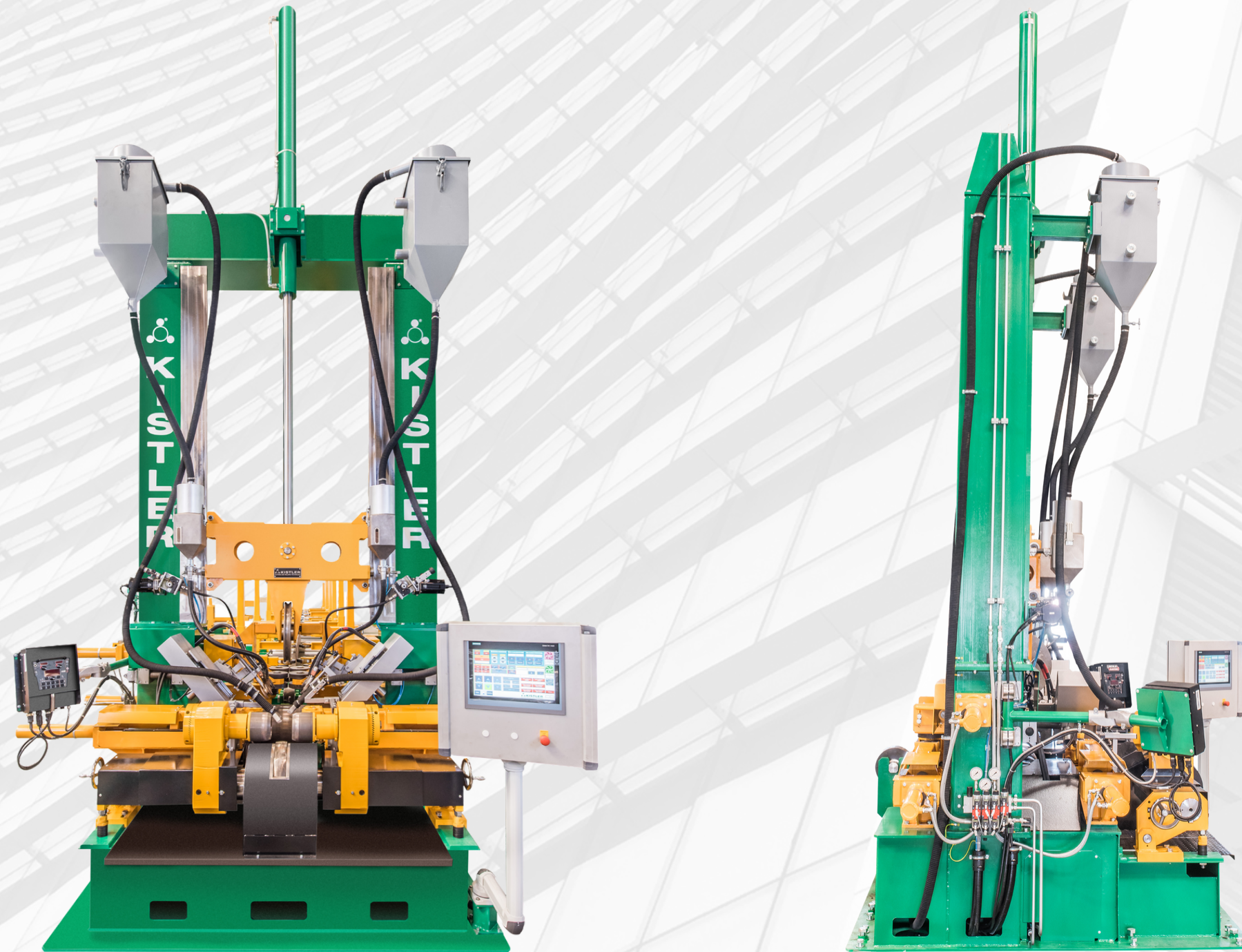

Turnkey Projects

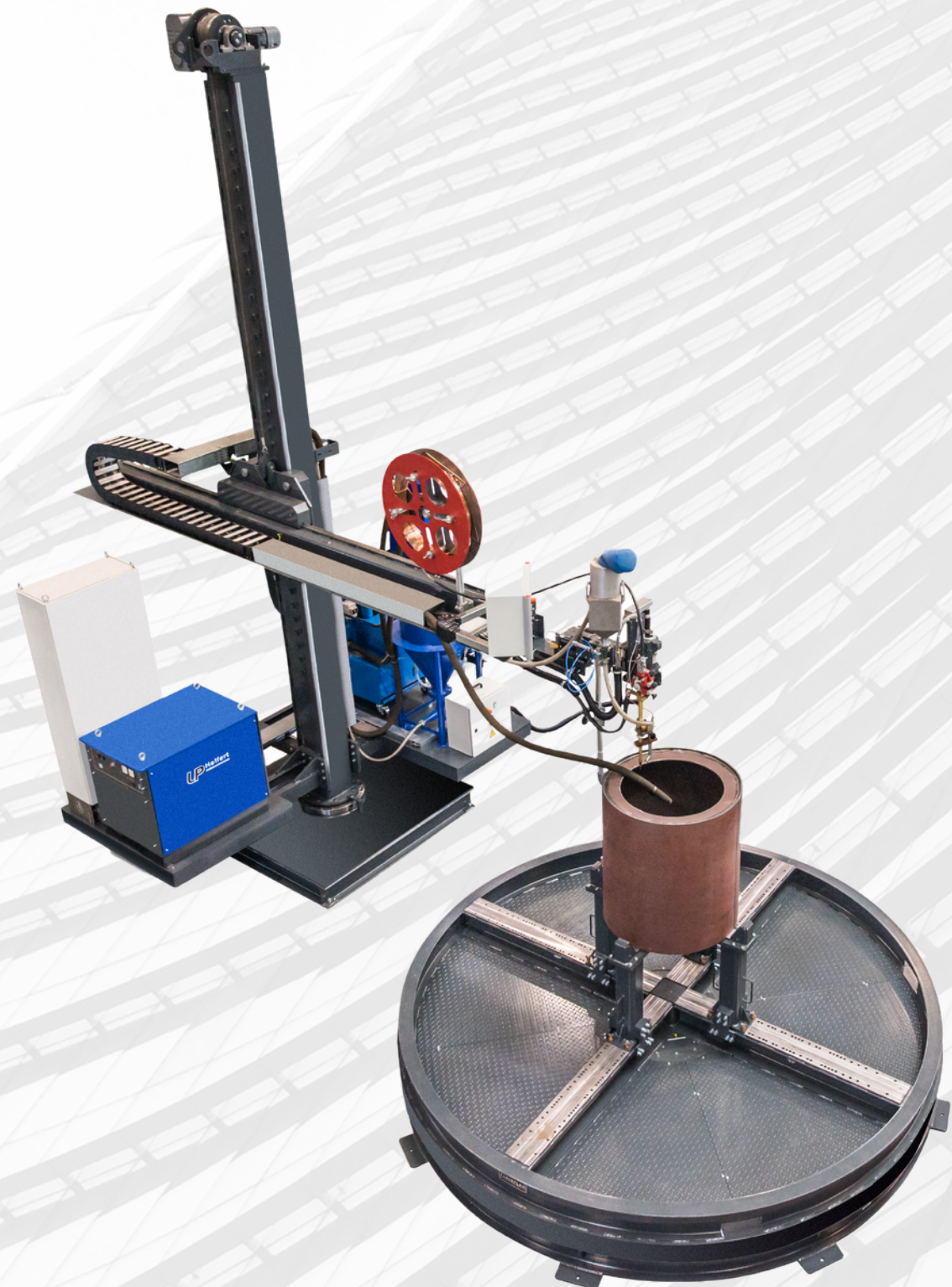

Value Added Products

PLC-controlled cost-effective pipe profiling machine of the SCM-Range:
from 25 mm up to 630 mm pipe diameter / from 1" up to 2' pipe diameter



Also available:

- SCM300: from 25 mm up to 300 mm pipe diameter / from 1" up to 12" pipe diameter
- SCM400: from 25 mm up to 400 mm pipe diameter / from 1" up to 16" pipe diameter

Value Added Products

Pipe Rotators of the U-Range: from 20 mm up to 200 mm pipe diameter /
from 1" up to 8" pipe diameter



U150

Value Added Products

Pipe Rotators of the U-Range: from 20 mm up to 400 mm pipe diameter /
from 1" up to 16" pipe diameter

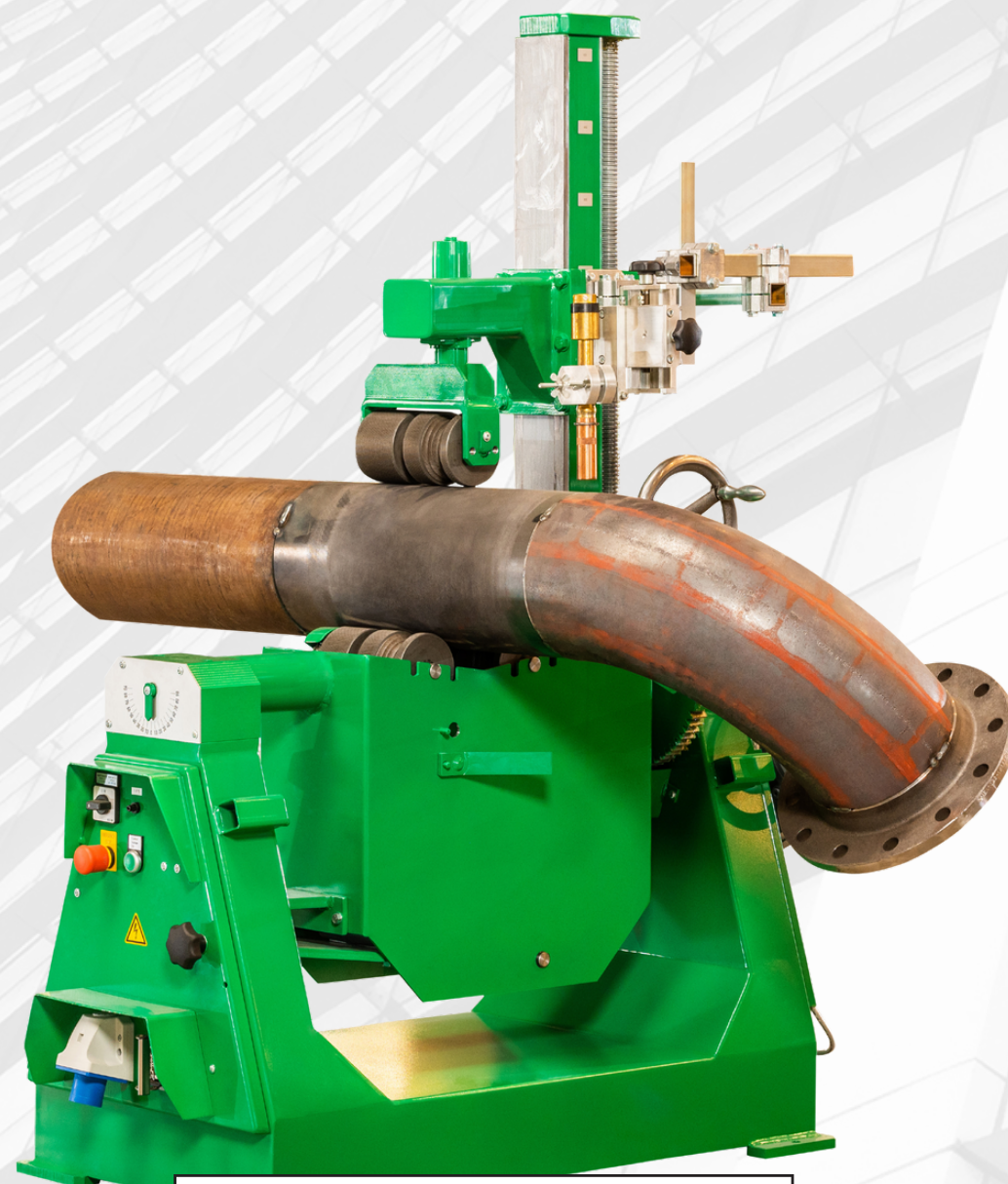
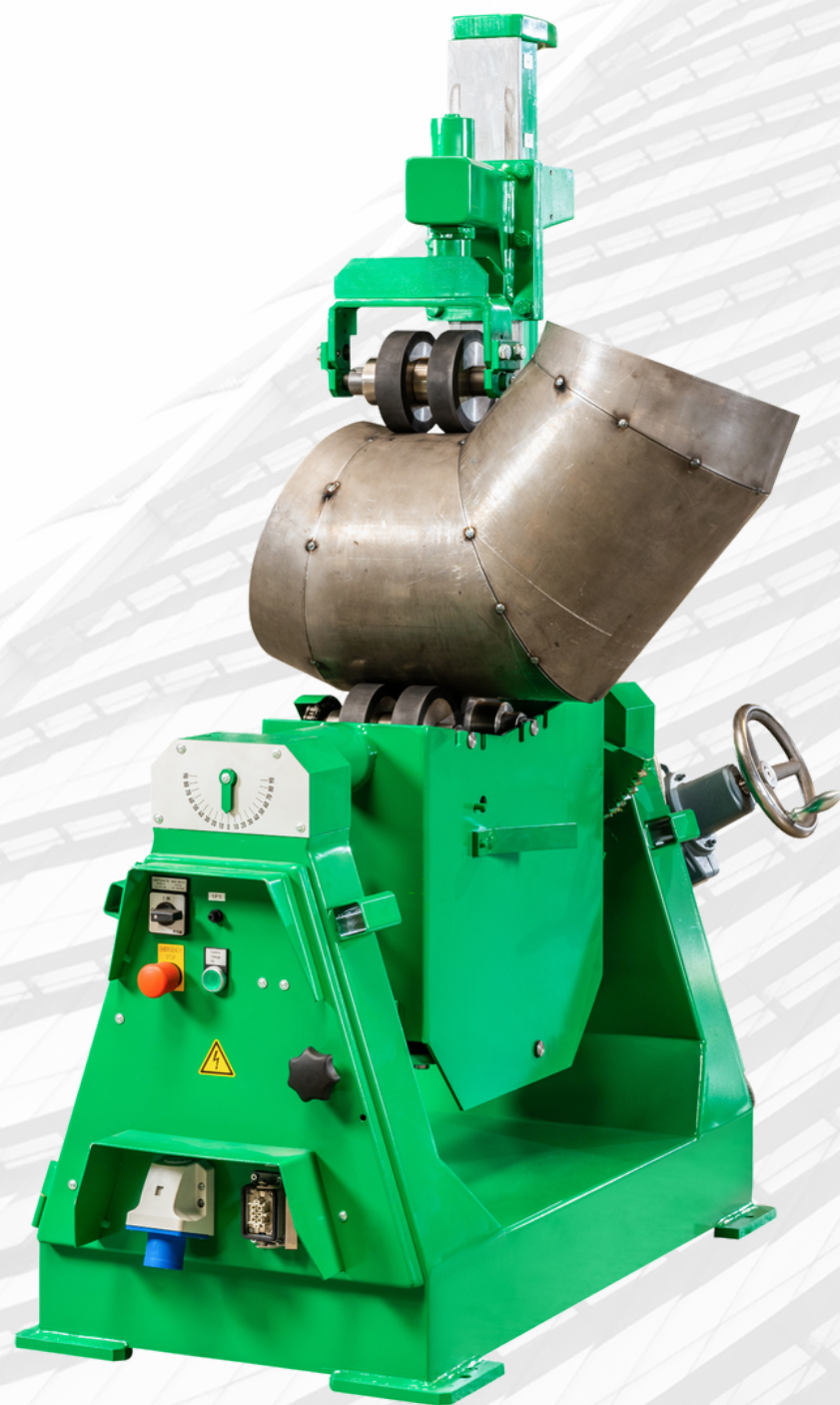

U500



Value Added Products

Pipe Rotators of the U-Range: from 50 mm up to 800 mm pipe diameter /
from 2" up to 32" pipe diameter

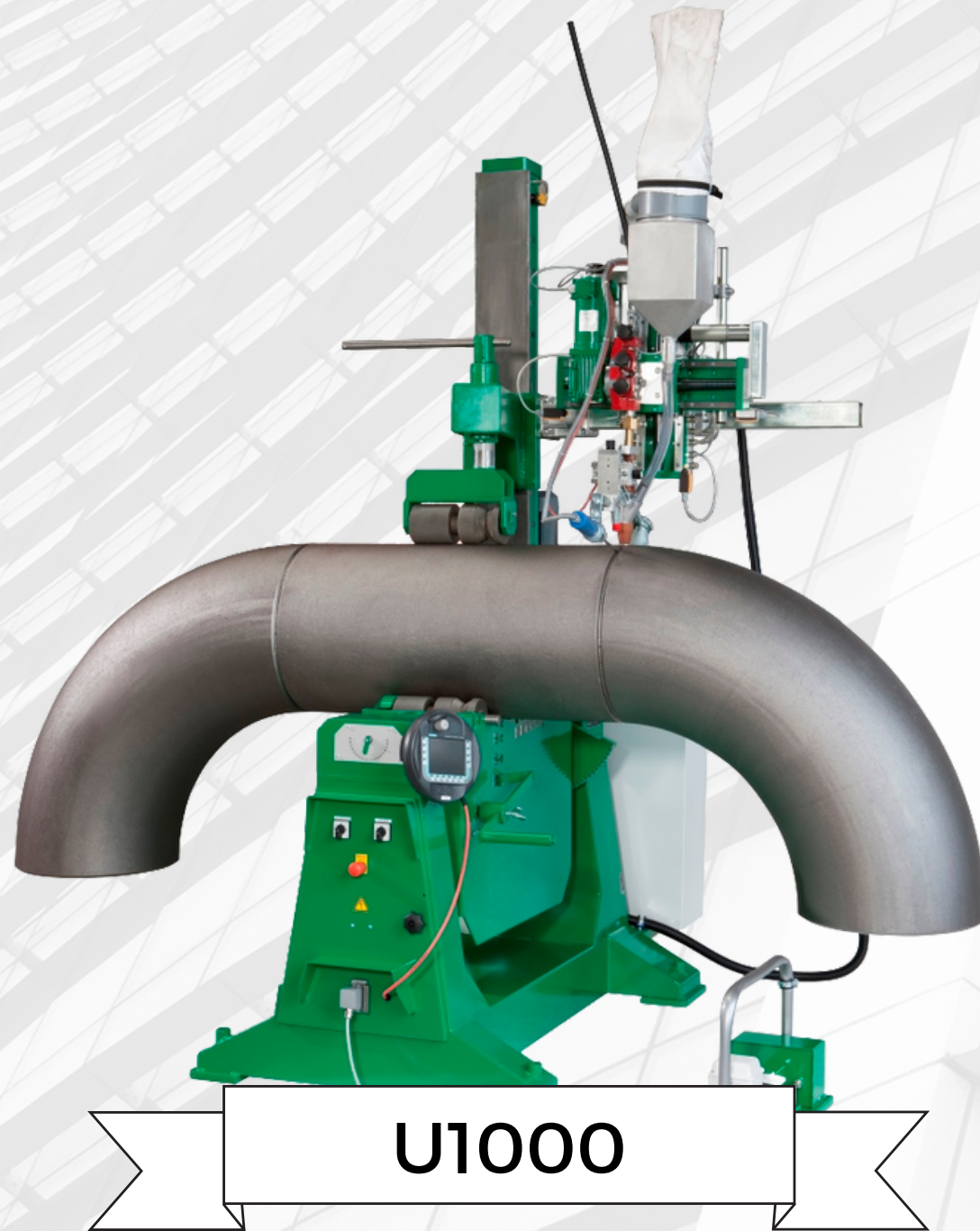

Advantages over traditional devices

Workpiece Variety

Pipes with elbows, tee pieces or other offset loads can be clamped as they are driven at their external diameter



Easy Flange Clamping

Quick precise centering and clamping of pipes and flanges without chuck, clamping shoe, etc.

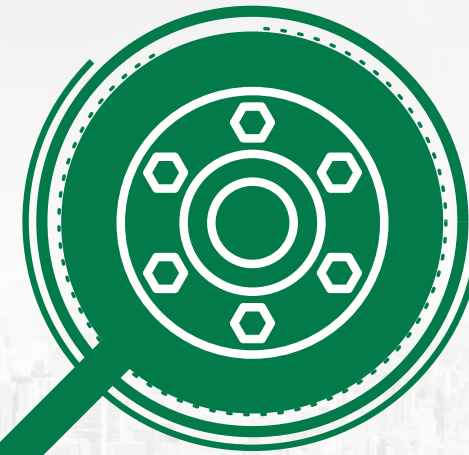

Pipe Centering

Two pipes with the same outside diameter can be clamped at their center of gravity



Versatile Applications

Various combinations are possible – e.g. clamping and driving of a main spindle

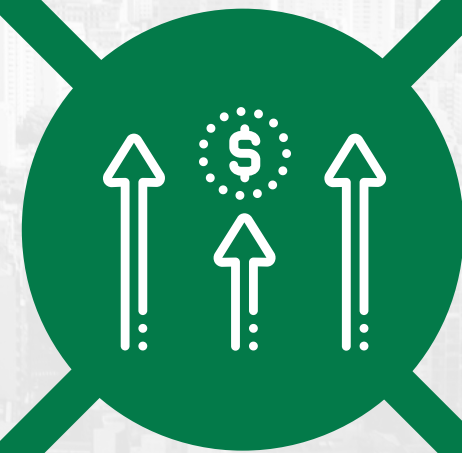

Advantages over traditional devices



Workpiece Variety

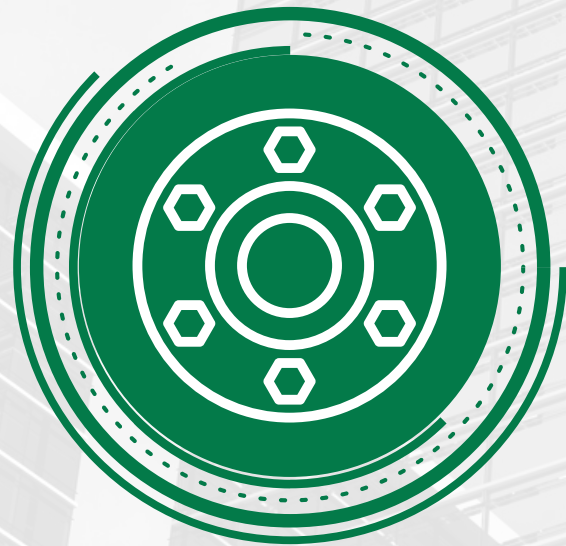

Flange Clamping



Pipe Centering



Versatile Applications

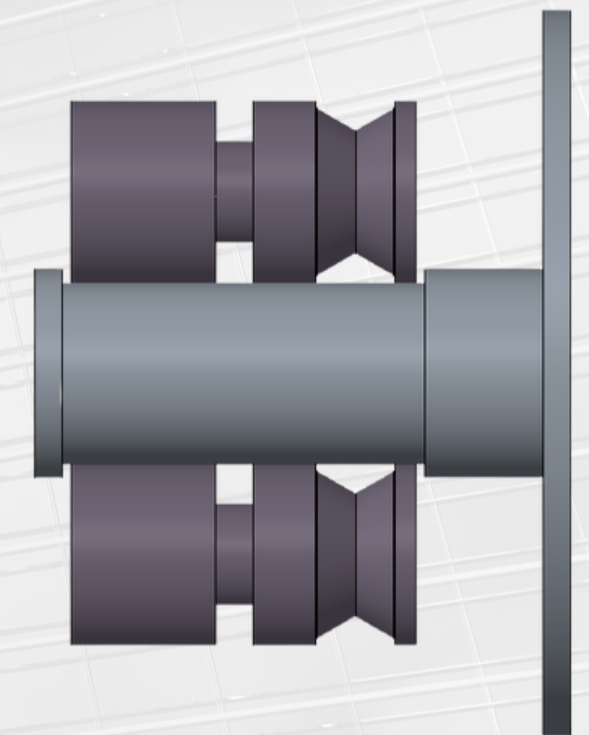
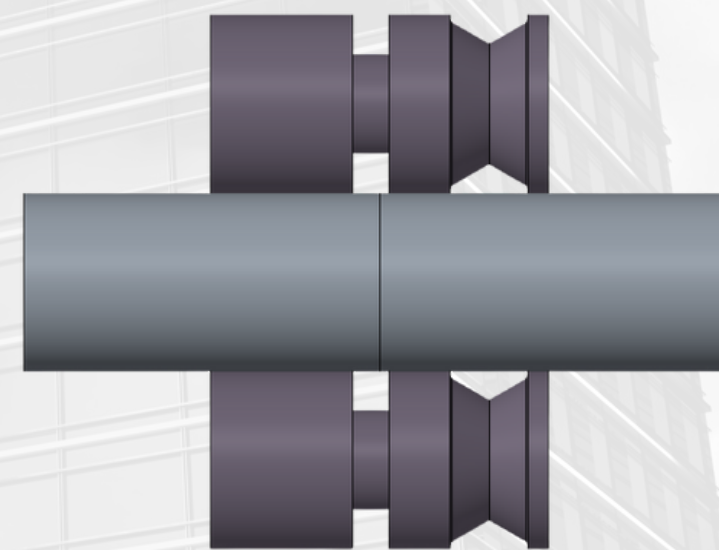
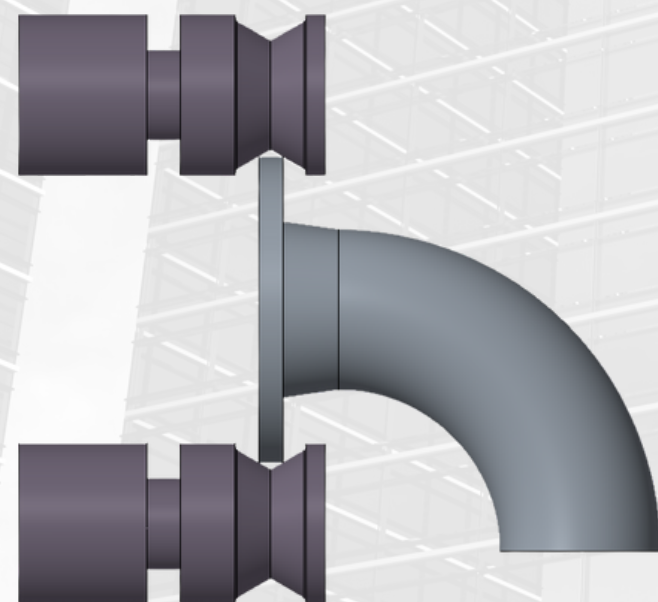
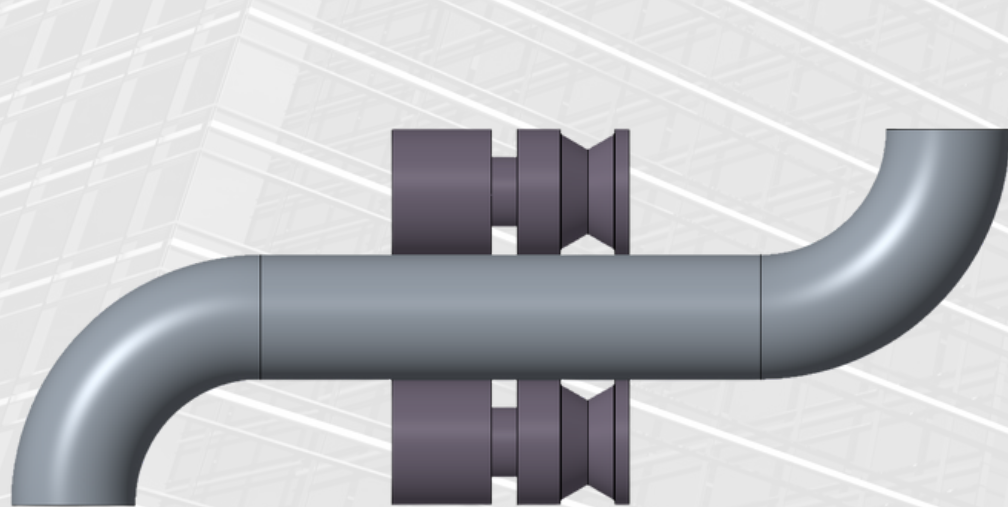

References (Oil & Gas)

- NPCC National Petroleum Construction Company (Abu Dhabi)
- McDermott (Dubai)
- ABB, Cameron, FMC
- Gulf Piping (Abu Dhabi)
- Consolidated Contractors Company, Athens (Greece)
- Petrojet, Cairo (Egypt)
- Schlumberger, Jekaterinenburg (Russia)
- Wacker Chemie, Burghausen (Germany)
- BASF, Ludwigshafen (Germany)

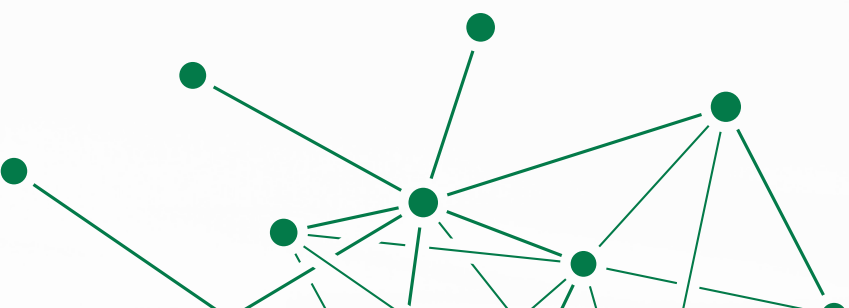

References (Energy & Pressure Vessels)

- Cimtas, Istanbul (Turkey)
- Machine Sazi Arak (Iran)
- Hyundai (Korea)
- Larsen & Toubro (India)
- GEC / Alsthom (India)
- Equipos Nucleares (Spain)
- Nooter, St. Louis (USA)
- Siemens, Berlin / Nürnberg (Germany)
- Babcock & Wilcox (Spain)
- BHEL (India)
- DWE, Deggendorf (Germany)
- Linde, Tacherting (Germany)
- Rolls Royce, Derby (UK)

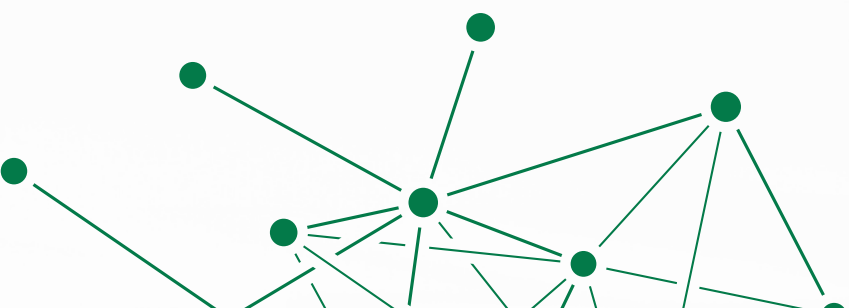

References (Pipe Mill Equipment)

- EEW, Erndtebrück: >20 systems
- EEW, Korea: 7 systems
- EEW, Rostock: 13 systems
- Nova Hut, Ostrava (Czech Republic)
- Bergrohr, Siegen (Germany)
- Bender-Ferndorf Pipe GmbH (Germany)
- Westfalenwerk Grebe GmbH & Co., Kreuztal (Germany)
- Cimtas Pipe, Gemlik (Turkey)

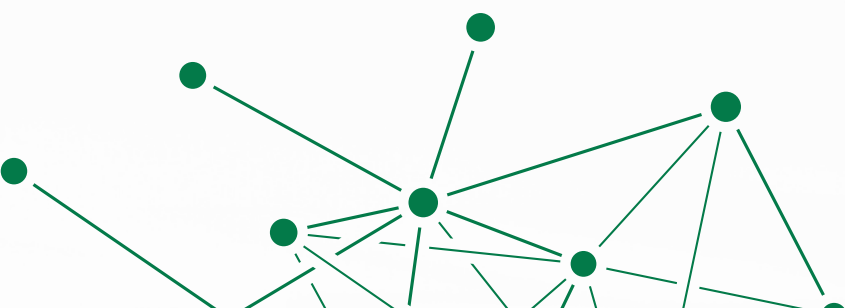

References (Shipbuilding)

- Meyer, Papenburg (Germany)
- Kvaerner, Rostock (Germany)
- Samsung, Koje (Korea)
- Volkswerft Stralsund (Germany)
- Hudong, Shanghai (China)
- Fincantieri, Trieste/Marghera (Italy)
- Guangzhou Shipyard (China)
- HDW, Kiel (Germany)
- Daewoo, Koje (Korea)
- Chantiers de l'Atlantique, Nantes (France)
- Philly Shipyard, Philadelphia (USA)
- Keppel AmFELS, Brownsville (USA)
- Vosper Thornycroft, Southampton (UK)

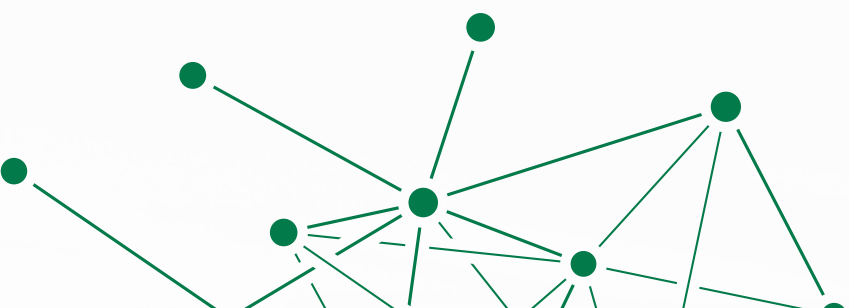

References (Wind Energy Production)

- Ambau GmbH (Gräfenhainichen, Dessau, Bremen, Cuxhaven)
- CAS, Strassfurt (Germany)
- CSC, Cuxhaven (Germany)
- GSD, Dessau (Germany)
- FAM, Magdeburg (Germany)
- KGW, Schwerin (Germany)
- SIAG (Finstertal, Leipzig, CZ-Chrudim, F-Le Creusot)
- Steelwind Nordenham (Germany)
- CRIST, Gdansk (Poland)
- Gandara Censa (Spain)
- Max Bögl, Neumarkt (Germany)

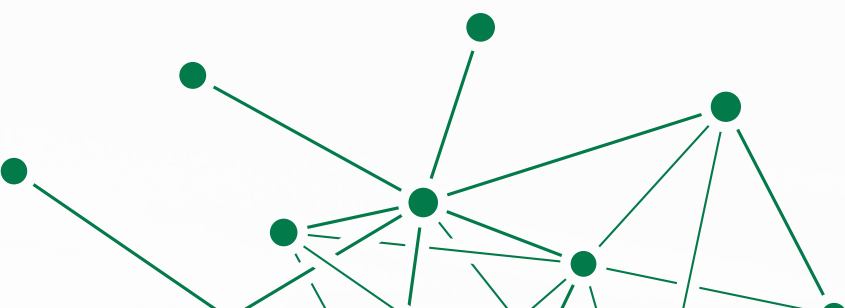



Contact Us

The Special Is Our Standard!

In order to serve the customer's need best, KISTLER will not only supply a large range of standard equipment but also design and manufacture automation equipment according to customer's specific needs.

 Mackstrasse 84
88348 Bad Saulgau
Germany

 +49 7581 48882-0

 info@kistler-machine.de

 www.kistler-machine.com